

PROMOTECH

MaxX[®]

Powerful,
Safe,
Compact,
Easy to handle

Hand
controlled
magnetic
lifters



Ideal for
handling
finished or rough,
flat or round
ferrous loads

**3-year
guarantee**
International
Patent



MaxX[®]

MaxX - The most practical, safe and economical way to lift ferrous loads

MaxX lifters are a real revolution in magnetic handling of ferrous loads. Absolute compact dimensions and low weight, great power and total work safety are the qualities, which make MaxX the ideal solution for small and large factories in the industry, with near zero operating costs and quick return on investment. A range of 10 models is available with lifting capacity from 125 kg (270 lbs) to 2000 kg (4300 lbs). Easy to use and manage, they give huge advantages through increased efficiency and productivity in a great number of applications even with limited handling space and short range hoisting or lifting equipment.

Ideal for handling workpieces in machine tools and oxygen cutting operation, for plates, sheet and iron blocks in steel structural works and shipyards building, in steel industries and distribution centres, for changing tooling in production and in general for all the requirements of the modern mechanical workshops. A single operator can handle the load which is always anchored and lifted from the top without deformation or damage and with optimal use of the available work space, perfect human engineering and full safety for men and equipment.

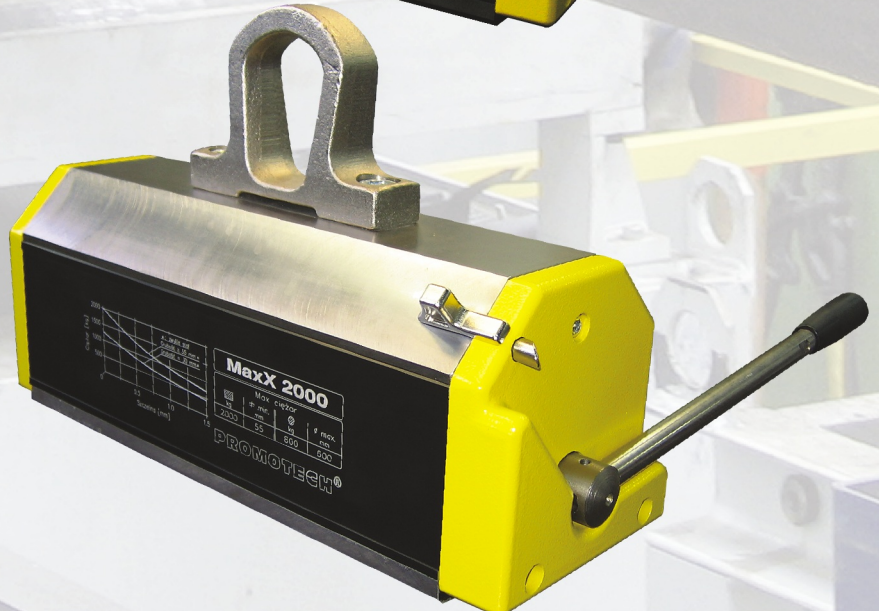
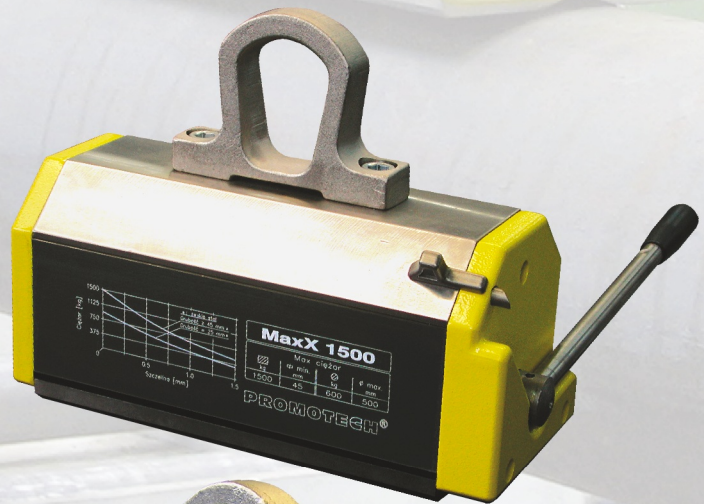
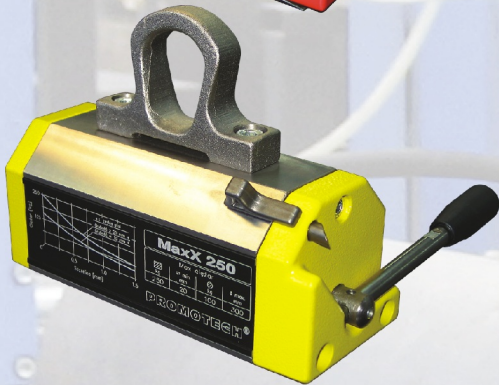
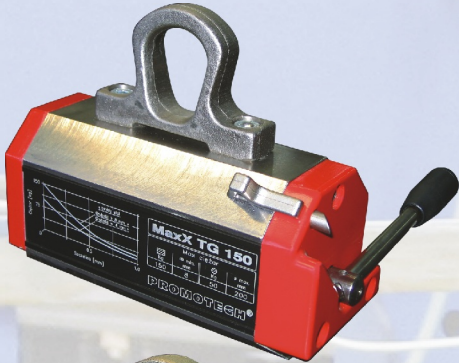

Safety factor
3

MaxX[®] The lifters of the ultimate generation

The load is held only by the power of the permanent magnets with no power supply from the mains

Unbeatable features and performance for a great engineering development

Safe power

High-energy permanent magnets ensure great concentrated and constant power for an indefinite period. The 3:1 safety factor of the recommended load to the test load ensures optimal working conditions even with substantial operating air gaps. The high magnetic strength of the MaxX is shown by the strong resistance to operate de handle when load conditions are not perfect. That's how MaxX gives warning of potential danger.

Concentrated power

The "neutral crown" circuit, basic patent of all MaxX lifters, allows channeling the magnetic flow through the polar area only, i.e. where the power is needed this ensure steady, optimal performance whilst a total lack of magnetic dispersion avoids undesired attraction from adjacent loads.

Compact and Robust

Test load up to 150 times the weight of the lifter body (MaxX250). This incredible power to weight ratio is provided by MaxX double-magnet circuit (rotor and stator) and the revolutionary mono block construction. Simply turning the handle MaxX get activated or deactivated, A self-locking device prevents any possible accidental deactivation of the handle when in the MAG position.

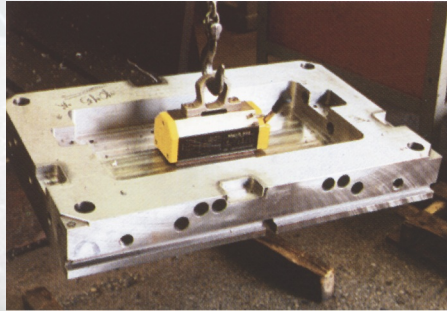

Reliability

The only moving part, the rotor, has its fulcrum on ball bearings and doesn't develop any physical contact during rotation.

Nickel coating

Nickel coating of all steel parts prevents rust formation, improves component life and allows better surface hardness in the polar area to maintain optimal load contact conditions and protection of machined surfaces.



MaxX activation and deactivation phases. The simplicity of a single move.

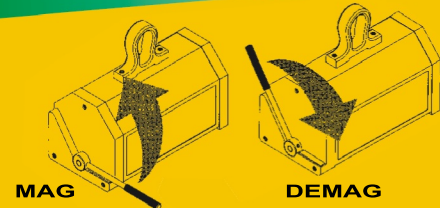

Simply turning the handle MaxX get activated or deactivated, A self-locking device prevents any possible accidental deactivation of the handle when in the MAG position.



MaxX TG

Greater flexibility with thin gage loads

Ideal solution for handling low thickness steel loads
in a safe and efficient way



Safety factor
3

MaxX TG - Evolution of the species

MaxX TG has been conceived to meet the demand for handling low thickness steel loads in a safe and efficient way. The special design of the polar surface together with a proper balancing of the magnetic masses located in the stator and in the rotor, allows to get the magnetic flux being concentrated in a closer distance. The rotation of the handle remain gentle whilst keeping high characteristics of uniform magnetic strength all over the contact area.

- Solid Block construction
- High Power rare heart permanent magnets
- Special treatment on all surfaces for corrosion and wear protection



DEDICATED TOOLS

MaxX Vertical System

Tecnomagnete suggest a line of devices for MaxX lifters to increase the flexibility of use in many applications for horizontal and vertical handling.



MVS

MaxX Vertical System

Model	A	B	Weight
	mm	mm	kg
MVS 250	750	250	12
MVS 500	1000	300	15
MVS 1000	1000	350	16

„MVS system is design for vertical handling of steel blocks. MVS is available for MaxX 250/500/1000”

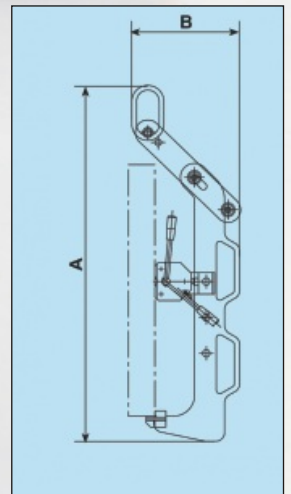

MAXX FIXED BEAM

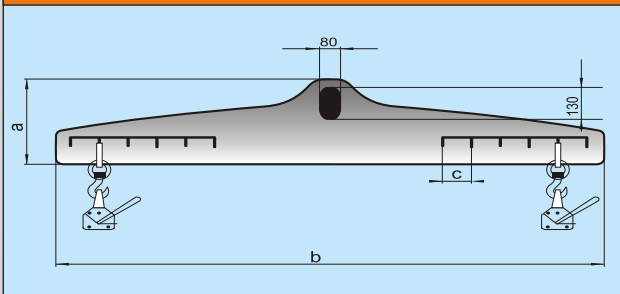

Model	Weight	Load Max	Dimensions (mm)			Max length plate
	(kg)	(kg)	a	b	c	(mm)
MFB 500	37	500	300	1680	100	3000
MFB 2000	75	2000	415	1900	100	3000

Technical data

Model	Weight kg	Dimensions (mm)						
		A	B	C	D	E	F	G
MaxX 125	3,7	122	177	79	79	82	39	35
MaxX 250	6,5	189	185	79	79	63	43	35
MaxX 300E	6,5	189	185	79	79	63	43	35
MaxX 500	15,0	249	235	106	101	88	60	52
MaxX 600E	15,0	249	235	106	101	88	60	52
MaxX 1000	32,5	342	316	133	131	88	60	52
MaxX 1500	61,0	383	457	166	171	122	87	64
MaxX 2000	76,0	457	457	166	171	122	87	64
MaxX TG 150	6,5	189	174	79	79	63	43	35
MaxX TG 300	16,0	250	165	106	102	88	60	52

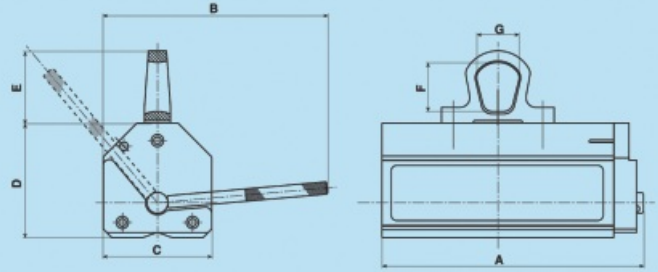

Load Characteristic

Model	Max Load kg	Min. Thickness mm	Max Length mm	Max Diameter mm
MaxX 125	125	20	1000	—
MaxX 250	250	20	1500	—
MaxX 300E	300	20	1500	—
MaxX 500	500	25	2000	—
MaxX 600E	600	25	2000	—
MaxX 1000	1000	40	3000	—
MaxX 1500	1500	45	3000	—
MaxX 2000	2000	55	3000	—
MaxX TG 150	150	8	1500	—
MaxX TG 300	300	10	2000	—
MaxX 125	50	10	1000	300
MaxX 250	100	10	1500	300
MaxX 300E	120	10	1500	300
MaxX 500	200	15	2000	400
MaxX 600E	240	15	2000	400
MaxX 1000	400	25	3000	450
MaxX 1500	600	30	3000	500
MaxX 2000	800	35	3000	600
MaxX TG 150	60	8	1500	240
MaxX TG 300	120	10	2000	290

Force/Load Curve – AirGap Max

on common Fe 370B steel poles completely covered

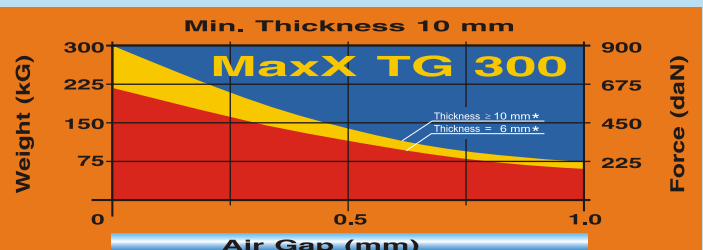
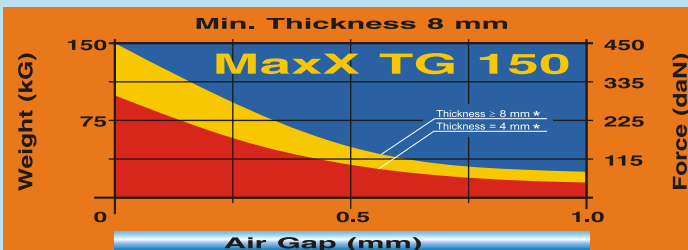
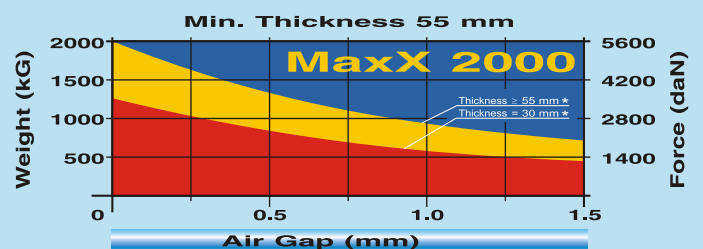
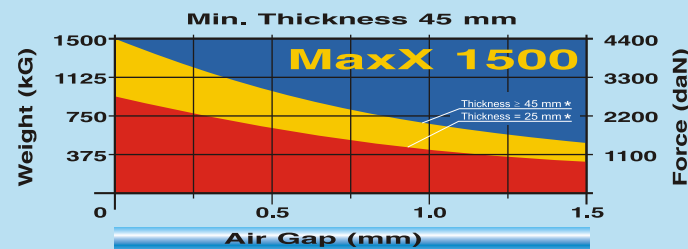
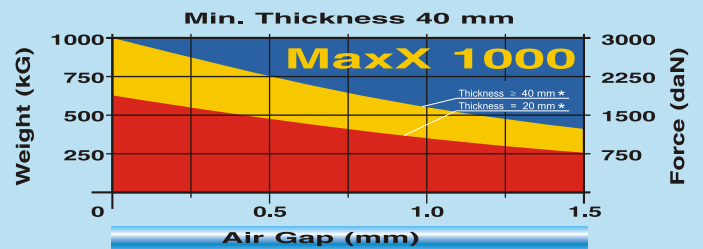
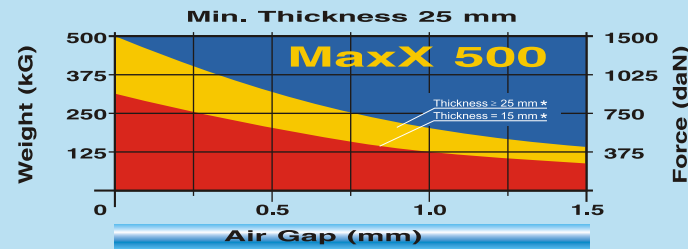
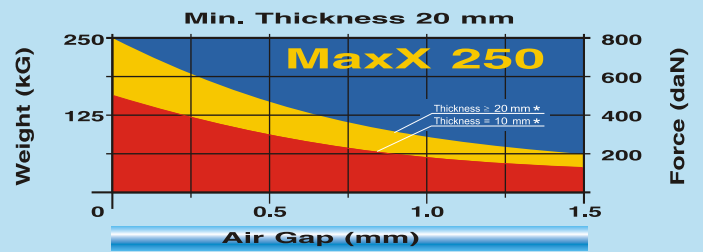
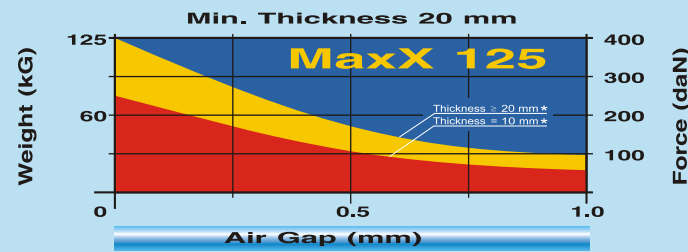
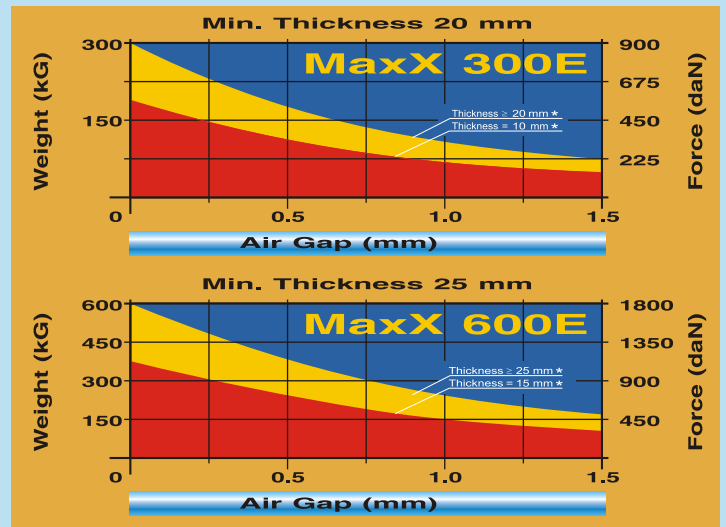
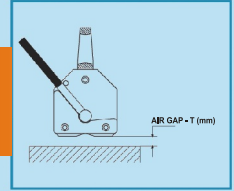



HIGH EFFICIENCY

The load can be stacked in layers without requiring spacers and is always lifted from above, without causing any deformation or damage. Working and storage areas are optimized.



Long Charge

More than 500 loading/unloading operations without recharging the batteries. Effective energy consumption.

Maximum Freedom

The remote control enables the unit to be operated at a distance (up to 30 m) even in difficult areas to access.



BAT GRIP

BAT GRIP

Series 300N

**Electro-permanent
Battery-operated
magnetic lifter
with remote control**

Ideal to handle loads of any dimension and shape

Concentrated Force

The neutral crown system enables the full force to be concentrated only on the poles, thereby ensuring the module's complete insulation in relation to adjacent ferrous loads at the same time.

Maximum Safety

The load is held exclusively by the force of the permanent magnets, which remains constant for an period, without requiring any other electric power supply.

**3-years
Warranty**



BAT GRIP

Series 300N

Mono block construction
Compact size
Low weight

Electro-permanent Battery-operated magnetic lifter with remote control



INNOVATIVE TECHNOLOGY

The technology of the QUADSYSTEM patent developed by TECNOMAGNETE has enabled a polar area to be created comprising 4 quadrangular poles arranged in a staggered layout that will be able to generate a large concentrated force through a horizontal and flattened circulation of the magnetic flux. The reversible double magnet circuit enables immediate magnetising without any residual magnetism.

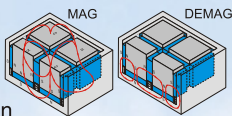

OPERATING BAR

360° tubular protection allows the lifter device to be handled easily, as well as avoiding accidental damage.



TOTAL CONVENIENCE

The absence of thermal stress in the electropermanent circuit enables the module to remain perfectly cold to ensure extended reliability without requiring specific maintenance. The Bat-Grip lifter combines the advantages of the intrinsic safety typical of an electro-permanent magnetic system with the practical and simple features of a battery-powered electronically controlled unit.

DAUTANAC SYSTEM ANTI-ACCIDENTAL DEACTIVATION

A magnetic sensor prevents operation of the magnetising and demagnetising controls (MAG/DEMAG) whenever handling operations are performed with the load raised above ground level. These operations may only be performed when the lifting hook is not taut or with the load on the ground.



CYCLE FREQUENCY

The magnetising and demagnetising cycles last approximately 1 sec. This can be performed using either the remote control or the push-button station on the lifting device.

EASY-TO-USE

Bat-Grip can be easily hooked to fixed or mobile lifting plants, thereby ensuring the best ergonomics in the workplace and total safety for the operators and equipment.

EASY HANDLING

The single block construction and the use of high-energy permanent magnets have made it possible to limit the weight and the size, making it remarkably strong and manageable.

TOTAL OPERATING FLEXIBILITY

Bat Grip enables work to be carried out without space and time limitations inside or outside production areas without electrical connections.

Easy to recharge

Bat Grip is supplied with a built-in battery charger, complete with recharging cable. Recharging can be conveniently carried out at weekends using a voltage of 220-240 V ac. for a period of 8 hours. The magnetising/demagnetising cycles are disabled if the battery charge is insufficient. This is indicated by a bright flashing light.

d.c. Batteries:	2x12V
Capacity:	30Ah
Charging time:	8h
Charging voltage:	220-240VAC
Type of battery:	Stationary lead Standardized

Load characteristics

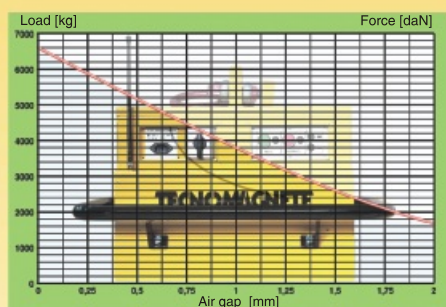

Flat load

Max load	3000 kg
Max length	3000 mm
Max width	2500 mm
Min thickness:	25 mm



Round load

Max load	700 kg
Max length	2000 mm
Max width	150 mm
Min thickness:	25 mm

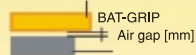

N.B.: Force/magnetic gap curve for a piece with a thickness of 40 mm (1.57 inch)

Technical data

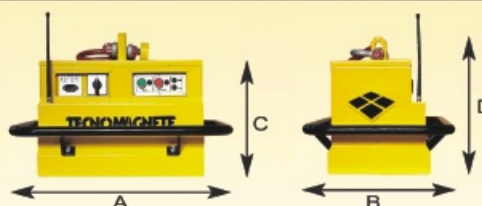

A (length)	690 mm, 27 in.
B (width)	328 mm, 13 in.
C (height)	490 mm, 19.3 in.
D (with ring)	660 mm, 26 in.
Weight	160 kg, 352 lbs

All information is subject to change without further notice

PROMOTECH Sp. z o.o.

ul. Elewatorska 23/1, 15-620 BIAŁYSTOK, POLAND
tel. (+48 85) 678 34 05, fax (+48 85) 662 78 77
marketing@promotech.eu www.promotech.eu



Your local Dealer: